

GETTING STARTED WITH YOUR BENLYSTA AUTOINJECTOR

Your guide to getting started

We have created this kit to help familiarize you with your BENLYSTA autoinjector, and to provide you with some helpful resources.

You are not alone in this journey.

There are many other resources available to people living with lupus or active lupus nephritis (lupus-related kidney inflammation).

Ask your doctor, nurse or pharmacist for more information.

Benlysta
(belimumab)  } **GSK**

SOME TIPS ON USING THE BENLYSTA AUTOINJECTOR



Here are some basics:

- Before you begin, read the **Instructions for Use** that come in every package.
- Use your medication on the **same day each week**.
- Your healthcare team will show you and your caregivers how to give the injections.
 - They will also review the **signs and symptoms of possible allergic reactions**.
- Inject **under the skin** of your **stomach (abdomen)** or **upper leg (thigh)**.
 - ⊘ **Do NOT** inject this medication into a vein.
- **Avoid injecting into the same site** each time.
 - You should also avoid areas where the skin is tender, bruised, red or hard.

GETTING STARTED: BUILDING A ROUTINE

As you begin your treatment, it's important to make it part of your weekly routine. You may find it helpful to associate your injection with a task you already do once a week, such as meal planning.

This leaflet is designed to help you feel more comfortable with your new weekly routine.

BE PATIENT AND ASK FOR HELP WHEN NEEDED

The BENLYSTA autoinjector is a pre-filled single-dose autoinjector that you will use to give yourself weekly injections. Giving yourself injections may take some time to get used to.

Your doctor and/or nurse will show you how to use the autoinjector properly. He or she may even supervise your first injection.



If you need more information, your healthcare team is there to help train and encourage you.



Ask your healthcare team to share the self-injection training video with you.

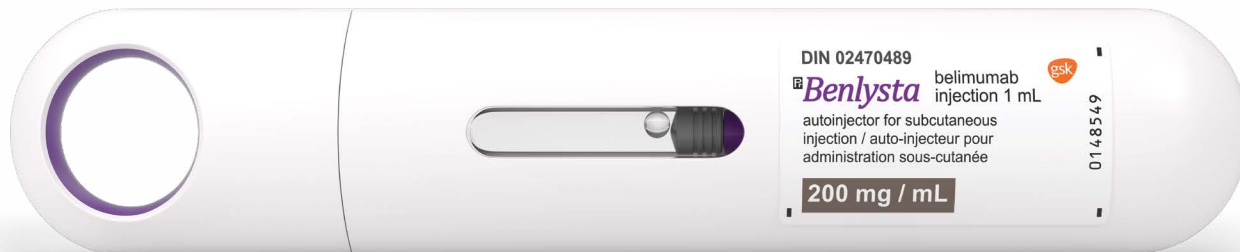

Once-weekly autoinjector

INSTRUCTIONS FOR USE

Once-weekly BENLYSTA (belimumab) autoinjector for subcutaneous injection

Please read the **Instructions for Use** on the next page, as well as the **Consumer Information**.

And remember that the autoinjector is for **subcutaneous** (under the skin) **use only**.

Important warnings

The autoinjector should be used only once and then discarded.

- ⊘ **Do not** share your autoinjector with another person.
- ⊘ **Do not** shake.
- ⊘ **Do not** use if dropped onto a hard surface.
- ⊘ **Do not** remove ring cap until right before the injection.

Autoinjector parts

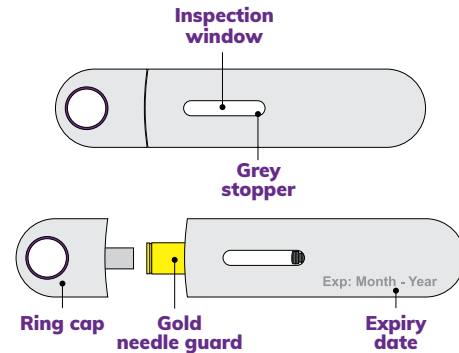

Supplies needed for the injection

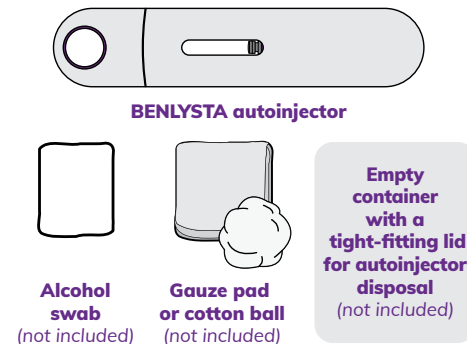

1 GATHER AND CHECK SUPPLIES

Gather supplies

- Remove a sealed tray containing a pre-filled autoinjector from the refrigerator.
- Find a well-lit and clean surface, and arrange the following:
 - BENLYSTA autoinjector
 - Alcohol swab (not included)
 - Gauze pad or cotton ball (not included)
 - Empty container with a tight-fitting lid for autoinjector disposal (not included)
- ⊘ **Do not** perform the injection if you do not have all the supplies listed.

Check expiry date

- Peel back the film of the tray and remove the autoinjector.

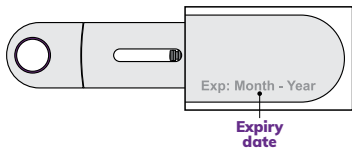

- ⊘ **Do not** use if the expiry date has passed.

2 PREPARE AND INSPECT THE AUTOINJECTOR

Allow to reach room temperature



- ⊘ **Do not** warm the autoinjector in any other way.
 - For example, do not warm in a microwave oven, hot water or direct sunlight.
- ⊘ **Do not** remove the ring cap during this step.

Inspect the solution

- Look through the inspection window to check that the solution is clear and colourless to slightly yellow in colour.
- It is normal to see one or more air bubbles in the solution.

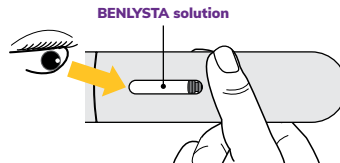

- ⊘ **Do not** use if the solution looks cloudy, discoloured or has particles.

3 CHOOSE AND CLEAN THE INJECTION SITE

Choose the injection site

- Choose an injection site (abdomen or thigh).
- Avoid injecting into the same site each time and areas where the skin is tender, bruised, red or hard.
- If you need 2 injections to complete your dose, leave at least 2 inches between each injection if using the same site.
- ⊘ **Do not** inject within 2 inches of the belly button.

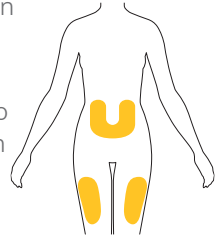

Clean the injection site

- Wash your hands.
- Clean the injection site with an alcohol swab.
 - Allow the skin to air dry.



- ⊘ **Do not** touch area again before the injection.

4

PREPARE FOR THE INJECTION

Remove the ring cap

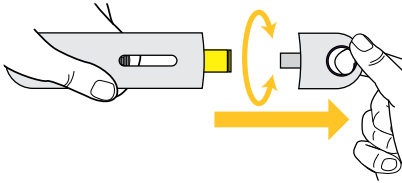

- Remove by pulling or twisting it off.
- ⊘ **Do not** remove the **ring cap** until right before the injection.
- ⊘ **Do not** put the ring cap back onto the autoinjector.

Position the autoinjector

- Hold the autoinjector comfortably so that you can see the **inspection window**.
 - This is important so that you can confirm a complete dose.
- If needed, firm the injection site by pulling or stretching the skin.
- Position the autoinjector straight over the injection site (90-degree angle).
 - Make sure the **gold needle guard** is flat on the skin.



5

INJECT

Start the injection

- Firmly press the autoinjector down onto the injection site and hold in place.
 - This will insert the needle and start the injection.



- You will hear a “click” at the start of the injection and see the **purple indicator** start to move.

Complete the injection

- Hold the autoinjector down until you see the **purple indicator** has stopped moving.
 - You may hear a second “click” a few seconds before.
- The injection may take up to 15 seconds to complete.
- When complete, lift the autoinjector from the site.



6

DISPOSE AND INSPECT

Dispose of the used autoinjector

Proper disposal of your used autoinjector is very important. Please follow the instructions below.

- Do not put the ring cap back onto the autoinjector.
- Dispose of the used autoinjector and ring cap in an empty container with a tight-fitting lid.
- Ask your doctor, nurse or pharmacist how to dispose of a used autoinjector or container of used autoinjectors.
- ⊘ **Do not** recycle or throw the used autoinjector or container of used autoinjectors in household trash.

Inspect the injection site

- There may be a small amount of blood at the injection site. If needed, press a **cotton ball** or **gauze pad** on the site.
- ⊘ **Do not** rub the injection site.

ADDITIONAL INFORMATION



If you miss a dose:

- Give yourself the missed dose as soon as you remember.
- Then continue with your normal weekly schedule.
 - **Or** start a new schedule starting on the day the missed dose was received.

For example, if you usually inject yourself on Mondays, but realize on Tuesday that you forgot, give yourself your missed “Monday” dose right away, and then either:

- Continue with the following Monday, as before, OR;
- Switch your injections to Tuesdays.



Storing your autoinjector

- Store in your refrigerator (2° to 8°C).
- Keep the autoinjector in the original carton and out of the light.
- Safely throw away medicine that is out of date or no longer needed, in accordance with local safety requirements.
- **Remember to keep your autoinjector out of the reach of children.**
- ⊘ **Do not freeze.**
- ⊘ **Do not use** if left out at room temperature for **more than 12 hours.**



©2024 GSK group of companies or its licensor.
Trademarks are owned by or licensed to the GSK group of companies.

103826
04/24



Benlysta
(belimumab)  